

Required Software: SSH/Telnet Client

Steps provided using PuTTY. Download available here: <http://www.putty.org/>

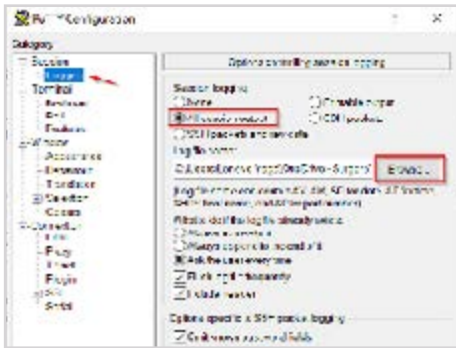

1 Open PuTTY and enable Logging of your session output

1a Click "Session" then "Logging" as shown to the left

1b In Options click "All session output" radio button

1c Choose the path and log file name to put the logging data

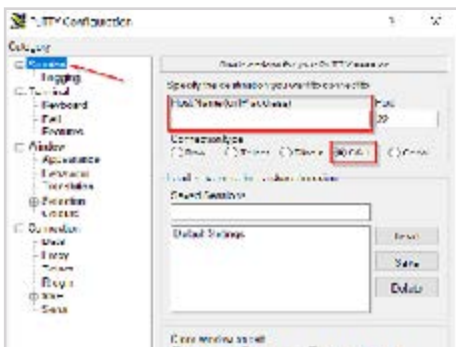

2 Click on Session, enter the reader's IP address, Select SSH, and hit Open



3 PuTTY Security Alert will open, select "Yes"

4 Log into the reader

4a Username: *root*

4b Password: *impinj*

5 At the > prompt type the following commands:

5a Check reader configuration: *show network summary*

5b Check LLRP connection: *show rfid llrp inbound*

5c Check log files: *show logging events err 1000*
show logging events app 1000

5d Exit the reader: *exit*